

Each month MSC's product section features items from all areas of the steel construction industry. In general, these products have been introduced within the past six months. If you're looking for a specific product, visit MSC's online product directory at www.modernsteel.com/products. You can browse by product category or search on any term to help find the products you need, fast.



Free Standing General Filtration

Lincoln Electric Automation's Circulator free-standing general filtration system provides weld fume control to supplement an existing source extraction system. The system is well-suited to manufacturing and fabrication facilities that have obstructions for ductwork, such as overhead cranes and large amounts of infrastructure, that make a push-pull system impractical. The Circulator is designed to create a cleaner work environment by reducing the amount of dust and dirt around the operator and in surrounding work areas. It features the Green-Drive Control System that relies on integrated controls and a state-of-the-art pressure sensor and that automatically adjusts airflow to maintain required performance levels. As an engineered solution, system is configured in detail based on an evaluation of specific operations layout and manufacturing processes.

For more information, visit www.lincolnelectric.com or call 888.355.3213.

Light Up Your Workspace

A new wheeled light cart from Larson Electronics is designed to provide powerful lighting on a mobile and easily deployed platform. The HAL-2X400C wheeled light cart carries two 400-watt metal halide lamps and is approved for Class 1 Division 2 hazardous locations. It illuminates up to 50,000 sq. ft of workspace. Featuring rugged aluminum and stainless steel construction, an SOOW explosion proof cord and solid rubber tires, this unit is designed to provide durable, reliable and safe illumination that can be easily moved about the workplace. The package is designed so operators can move the light heads from the cart to telescoping wheeled tripod, enabling their use in a wider variety of hazardous location environments while reducing the overall cost of acquisition.



For more information, visit www.magnalight.com or call 800.369.6671.

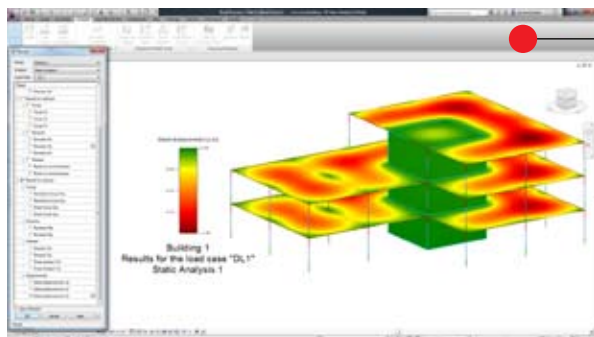

Structural Analysis in the Cloud

Autodesk has launched its Project Storm for public use, enabling Revit Structure users to perform cloud-based structural analysis. The application is offered online as a Technology Preview through Autodesk Labs. As with other online "labs" offerings, this allows the company to offer fully functional technologies that work with their other products but have not yet been incorporated into a standard commercial package. It also provides an excellent channel for user feedback on usability and applications.

Using Project Storm, Revit users can perform static analysis on BIM models that is done "in the cloud" rather than in the local computing environment. In addition to freeing up local computing resources, it also give users the benefit of using the same analysis engine that pow-

ers Autodesk's Robot Structural Analysis Professional 2012.

For more information, go to <http://labs.autodesk.com>, under Technology Previews.

All products submitted are considered for publication, and we encourage submittals related to all segments of the steel industry: engineering, detailing, fabrication, and erection. Submit product information via email to Tom Klemens (klemens@modernsteel.com). To be included in MSC's online products directory, contact Louis Gurthet (gurthet@modernsteel.com).